

FBE Series
SMD EMI Suppression Ferrite Bead
Size 0805



CHARACTERISTICS

- Monolithic inorganic material construction.
- Closed magnetic circuit avoids crosstalk.
- Suitable for reflow soldering.
- Available in various sizes.
- Quantity: 4000pcs

APPLICATION

- Data lines and low power lines
- Connection between digital and analog circuit

Dimensions: [mm]

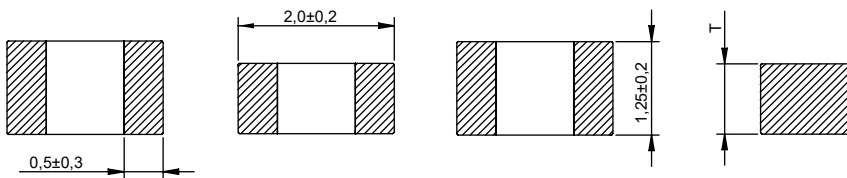

Land Pattern: [mm]

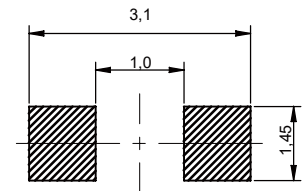

Electrical Properties:

Part No	Thickness T size (mm)	Impedance @100MHz (Ω)	Tolerance	DCR (max) (Ω)	Temperature Rise Current (max) (mA)
FBE0805-110-901R	0.85±0.20	11	±25%	0.10	900
FBE0805-170-601R	0.85±0.20	17	±25%	0.10	600
FBE0805-260-601R	0.85±0.20	26	±25%	0.10	600
FBE0805-300-601R	0.85±0.20	30	±25%	0.10	600
FBE0805-400-601R	0.85±0.20	40	±25%	0.10	600
FBE0805-600-901R	0.85±0.20	60	±25%	0.10	900
FBE0805-121-801R	0.85±0.20	120	±25%	0.20	800
FBE0805-151-801R	0.85±0.20	150	±25%	0.20	800
FBE0805-221-751R	0.85±0.20	220	±25%	0.30	750
FBE0805-301-701R	0.85±0.20	300	±25%	0.30	700
FBE0805-471-701R	0.85±0.20	470	±25%	0.35	700
FBE0805-601-501R	0.85±0.20	600	±25%	0.40	500
FBE0805-102-401R	0.85±0.20	1000	±25%	0.45	400
FBE0805-152-351R	0.85±0.20	1500	±25%	0.50	350
FBE0805-202-251R	0.85±0.20	2000	±25%	0.60	250
FBE0805-070-601R	0.85±0.20	7	±25%	0.10	600
FBE0805-300-701R	0.85±0.20	30	±25%	0.20	700

Part No	Thickness T size (mm)	Impedance @100MHz (Ω)	Tolerance	DCR (max) (Ω)	Temperature Rise Current (max) (mA)
FBE0805-600-701R	0.85±0.20	60	±25%	0.20	700
FBE0805-121-601R	0.85±0.20	120	±25%	0.25	600
FBE0805-151-601R	0.85±0.20	150	±25%	0.25	600
FBE0805-221-401R	0.85±0.20	220	±25%	0.30	400
FBE0805-301-401R	0.85±0.20	300	±25%	0.35	400
FBE0805-471-401R	1.25±0.20	470	±25%	0.40	400
FBE0805-601-301R	1.25±0.20	600	±25%	0.45	300
FBE0805-102-501R	0.85±0.20	1000	±25%	0.35	500

Operating Temperature: -55 °C ~ +125 °C

Temperature rise current the actual value of DC current when the temperature rise is ΔT40 °C

Impedance & Frequency Characteristics:

